

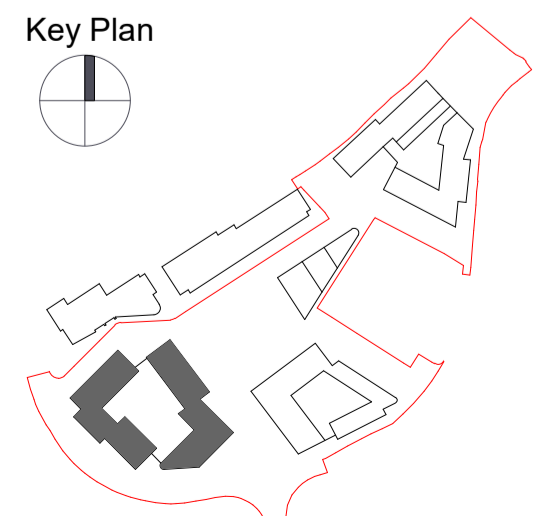

Block 15 Level G3



Refer to the following proposed site plan drawings for dimensions to neighbouring buildings and site boundary:

- 1730D-OMP-00-SPG1-DR-A-1000
- 1730D-OMP-00-SPG2-DR-A-1000
- 1730D-OMP-00-SPG3-DR-A-1000

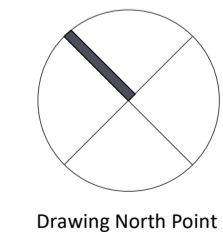

Revision Description	Date	Rev. No.	Issued by
SHD Pre-Application to An Bord Pleanála	20-10-2021	C01	CC
SHD Application to An Bord Pleanála	10-06-2022	C02	CC/AN
SHD Application to An Bord Pleanála - Window Change	22-06-2022	C03	CC/AN

**omahony pike**

architecture | urban design  
 email: info@omahonypike.com  
 tel: +353 1 202 7400  
 fax: +353 1 283 0822  
 www.omahonypike.com

Dublin  
 The Chapel  
 Mount St. Anne's  
 Milltown, Dublin 6  
 D06 XNS2 Ireland

Cork  
 One South Mall  
 Cork City  
 Co. Cork  
 T12 CCN3 Ireland

Project Code: 1730D  
 Project Lead: SD  
 Drawn By: SW  
 Job No.: 1730D  
 Purpose: Planning  
 Scale @ A1: 1 : 200  
 Date: 22-06-2022  
 Revision: C03  
 Status: A3

Project: Jacob's Island Strategic Housing Development  
 Location: Jacobs Island, Mahon, Co. Cork  
 Client: Hibernia Star Ltd.

Drawing Title: Block 15 Level G3  
 Drawing No.: 1730D-OMP-B15-G3-DR-A-1000

Figured dimensions only to be used. This drawing is copyright of O'Mahony Pike Architects Ltd. All information is shared as per approved use in accordance with ISO19650-2:2018, Table 5; Standard Codes for Suitability of Models and Documents and the BEP. If the 'Status' field is empty, this information has been shared at 50 - WIP.